

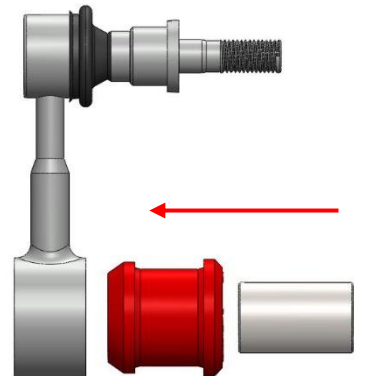

FITTING INSTRUCTIONS
7CE - Rear Drop Link Bush

Step 1: Remove existing OE bush including the outer metal shell. Ensure no sharp edges are left in the bore.

Step 2: Apply washing up liquid to the bushes leading flange and inner drop link bore.

Step 3: Push the bush with the leading flange facing towards the inside of the car until seated.
NOTE: Outer side of bush is marked.



Step 4: Insert tube until flush with bush.

Step 5: Place the washer on the outer side of the bush and push the bolt through.

Step 6: Refit drop link to the vehicle and tighten to OE specification when at ride height and the vehicle is settled.

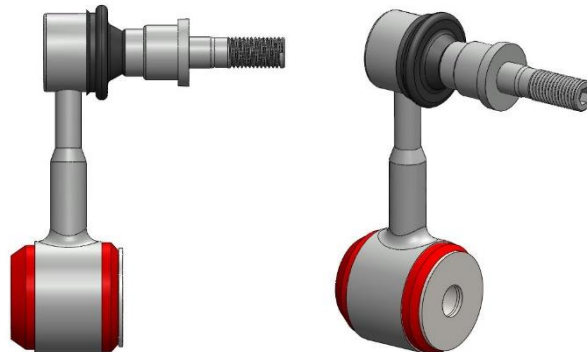
7CB, 7CC & 7CD Front and Rear Anti-Roll Bar Bushes

Step 1: Remove the OE bushes. Note: All OE bushes are glued to the Anti-Roll bars.

Step 2: Wrap the ARB bushes around the bar into the correct location.
NOTE: It is recommended to fit a jubilee clip to the bar at either side of the bush to ensure the bar cannot walk from left to right.

Step 3: Fit the ARB bracket around the bush ensure the bush is central.

Step 4: Refit the bar to the vehicle and tighten to OE specification when at ride height and the vehicle is settled.

If you have any questions regarding the fitment of these bushes, please give us a ring on 01978 664316 or send us an e-mail - sales@polybush.co.uk.