



FITTING INSTRUCTIONS

7CA - Rear Trailing Arm Bush



Step 1: Remove existing OE bush including the outer metal shell. Ensure no sharp edges are left in the bore.

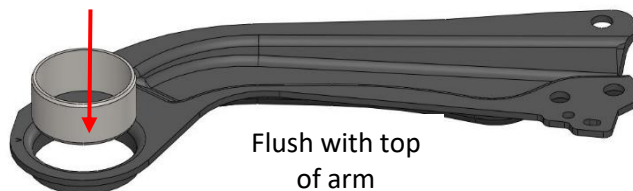

Step 2: Press the Polybush outer metal shell into the bore from the top of the arm (radiused side) until flush with the top side of the arm.



Step 3: Apply washing up liquid or similar to the leading edge flange, bore of the bush and the outer metal.

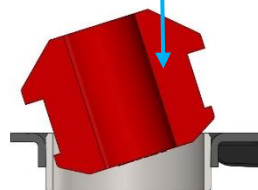

Step 4: Insert the bush into the housing at a slight angle and push until the flange pops through on the underside.

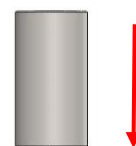

Step 5: Insert the inner tube until flush.



Step 6: Refit the arm to the bracketry and tighten to OE torque specifications at ride height. NOTE: Ensure suspension is settled.



If you have any questions regarding the fitment of these bushes, please give us a ring on 01978 664316 or send us an e-mail - sales@polybush.co.uk.