



**FITTING INSTRUCTIONS**

**44FN - Front Anti-Roll Bar Drop Link**

44FN has been designed to fit multiple vehicles using a combination of parts. Please select your vehicle and follow the relevant fitting instructions.

**OPTION 1** Part No. 8E0-411-317/8  
 Audi A4 B6 (8E2,8E5,8E7)(2000-2004)  
 Audi A4 B7 (8EC,8ED,8HE)(2005-2009)  
 Seat Exeo (3R2,3R5)(2008-2013)

**OPTION 2** Part No. 4D0-411-317-G/J/K  
 4D0-411-317-E/F  
 Audi A6 ALLROAD C5 (4BH)(2000-2005)  
 Audi A6 C6 (4F2,4F5,4FH)(2004-2011) Inc ALLROAD  
 Audi A8 D2 (4D2,4D8)(1997-2002)  
 Audi A8 (D3)(4E)(2003-2010)

**OPTION 3** Part No. 8D0-411-317/8-D  
 VW Passat B5/5.5 (3B2,3B5,3B5,3B6)(1996-2005)  
 Audi A4 B5 (8D2,8D5)(1994-2001)  
 Audi A6 C5 (4B2,4B5)(1997-2005)  
 Skoda Superb Mk1 (3U4)(2001-2008)

**OPTION 4** Part No. 8K0-411-317-E  
 8K0-411-317-D  
 E - Aluminium Drop Link  
 D - Plastic Drop Link  
 Audi A4 B8 (8K2,8K5,8KH)(2008-2016)  
 Audi A4 B9 (8W2,8WC,8W5,8WD,8WH,8WJ)(2015-On)  
 Audi A5 (8T3,8F7,8TA)(2009-2017)  
 Audi A5 (F53,F5P,F57,F5E,F5A,F5F)(2016-On)  
 Audi A6 C7 (4G2,4GC,4G5,4GD)(2011-2018)  
 Audi A7 Sportback (4GA,4GF)(2010-2018)  
 Audi Q5 (8RB)(2008-2017)

**OPTION 1**

Step 1:  
 Remove existing bushes.

Step 2:  
 Apply washing-up liquid or similar to a leading edge of the bush.

Step 3:  
 Push the bush into place using a vice or similar until fully seated.

Step 4:  
 Insert the inner tube with the flange facing the flat side of the link as shown.  
 RH Side Shown

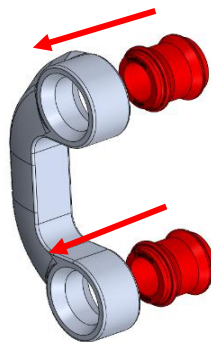

Parts Required (Per Link)
2 x Bushes
2 x Washers
2 x Inner Tubes
1 x Nyloc Nut

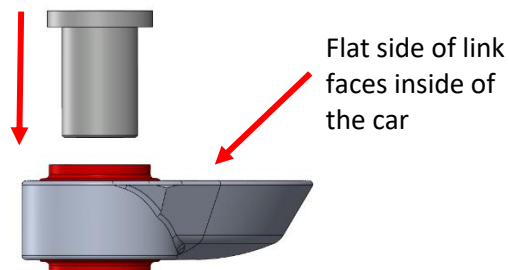

**Step 5:**  
Washers are to sit at the end of the tubes (Non Flange side). These should be facing the outside of the car as shown.

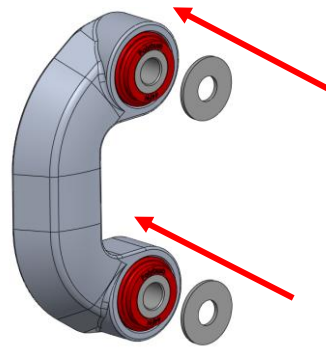

**Step 6:**  
Using the Nyloc nut provided, fit drop link back onto arm as shown.

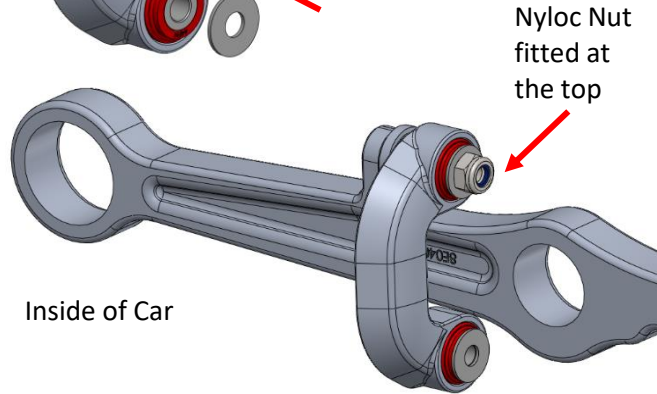

**Step 7:**  
Refit and torque to manufacturer's torque settings.

**Step 8:**  
Repeat process for LH link.

**OPTION 2**

**Step 1:**  
Remove existing OEM bushes.

**Step 2:**  
Apply washing-up liquid or similar to a leading edge of the bush.

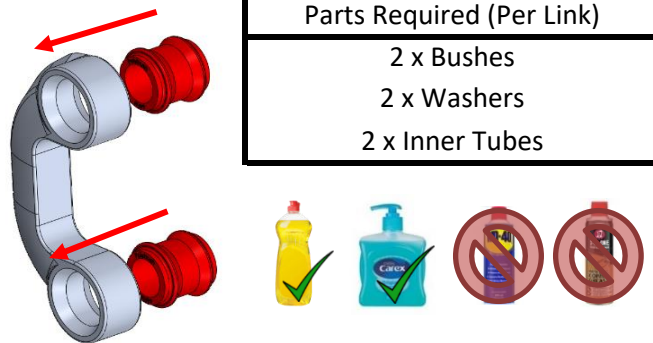

**Step 3:**  
Push the bush into place using a vice or similar until fully seated.

**Step 4:**  
Insert the inner tube with the flange facing the flat side of the link as shown.  
RH Side Shown

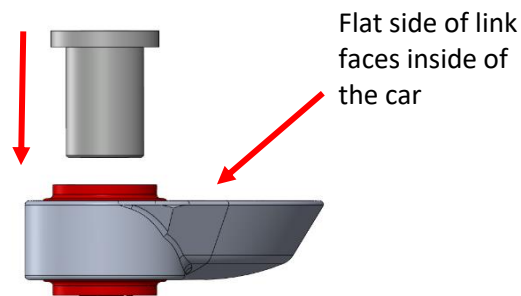

**Step 5:**  
Washers are to sit at the end of the tubes (Non Flange side). These should be facing the outside of the car as shown.

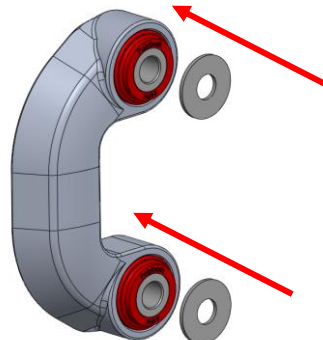

**Step 6:**  
Refit and torque to manufacturer's torque settings.

**Step 7:**  
Repeat process for LH link.

**OPTION 3**

**Step 1:**  
Remove existing OEM bushes.

**Step 2:**  
Apply washing-up liquid or similar to a leading edge of the bush.

**Step 3:**  
Push the bush into place using a vice or similar until fully seated.

**Step 4:**  
Insert the inner tube with the flange facing the flat side of the link as shown.  
RH Side Shown

**Step 5:**  
Washers are to sit at the end of the tubes (Non Flange side). These should be facing the outside of the car as shown.

**Step 6:**  
Using the Spacer provided, fit drop link back onto arm as shown. The spacer should be placed on the lower bush on the flanged tube section which connects to the Anti-Roll Bar.

**Step 7:**  
Refit and torque to manfacutuers torque settings.

**Step 8:**  
Repeat process for LH link.

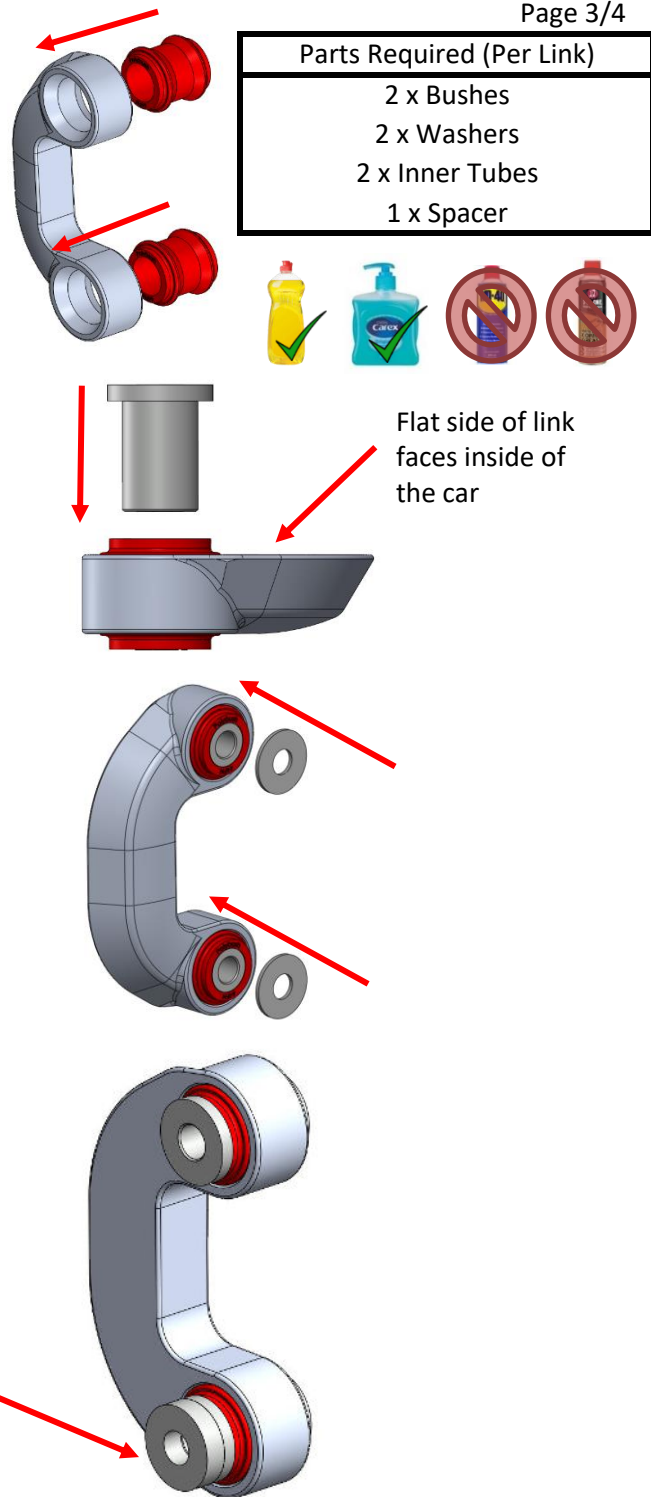

**OPTION 4**

44FN Covers both Aluminium and Plastic Drop Links.

Step 1:  
Remove existing OEM bushes.

Step 2:  
Apply washing-up liquid or similar to a leading edge of the bush.

Step 3:  
Push the bush into place using a vice or similar until fully seated.

Step 4:  
Insert the inner tubes with opposing flanges as shown.

Step 5:  
Washers are to sit on the end of the tubes (Non Flange side).

Step 6:  
Refit and torque to manfacutuers torque settings.

Step 8:  
Repeat process for LH link.

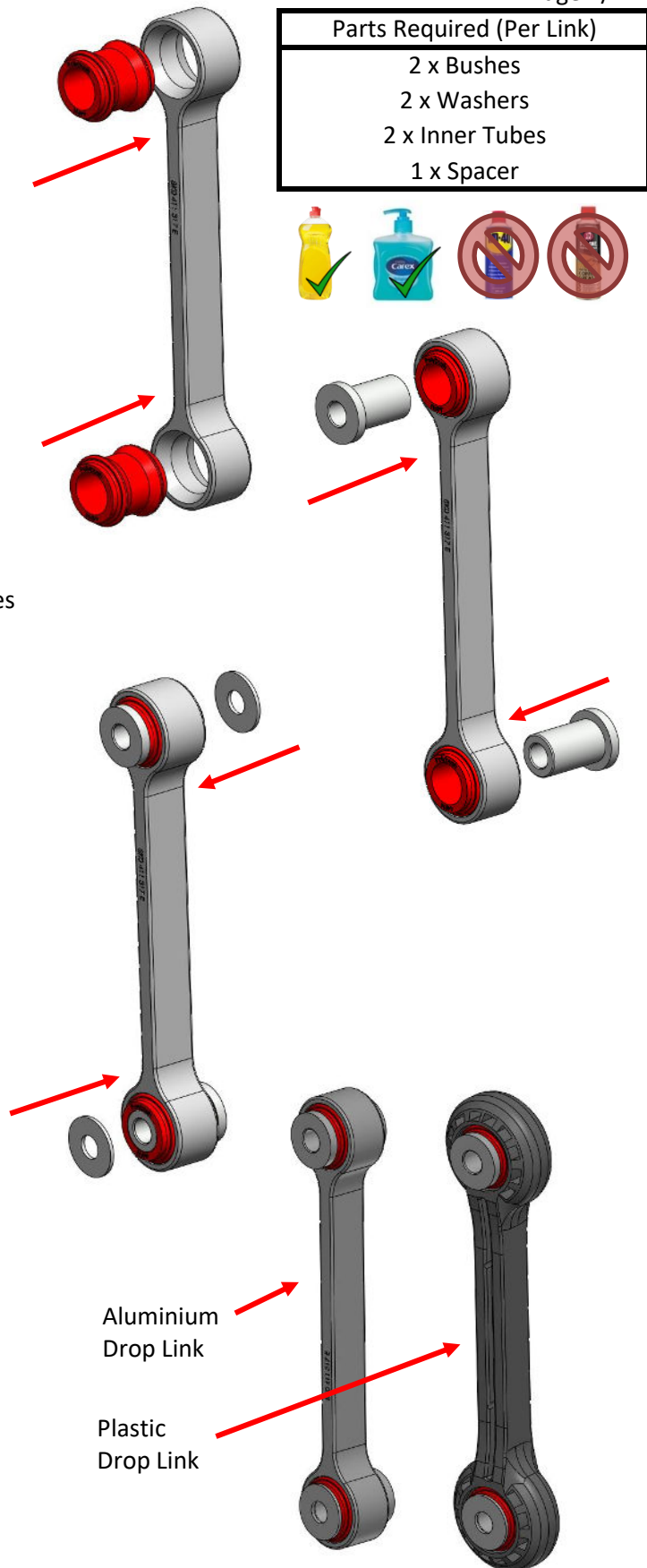

If you have any questions regarding the fitment of these bushes, please give us a ring on 01978 664316.

or send an e-mail to [sales@polybush.co.uk](mailto:sales@polybush.co.uk)