



FITTING INSTRUCTIONS

44FK - Front Lower Rear Control Arm

44FK Contains
2 x Bushes
2 x Inner Tubes
2 x Outer Tubes



Step 1:
Remove the existing bushes.

Step 2:
Insert the Outer Tube using a hydraulic press or similar until the lipped face touches the flat machined face of the arm.

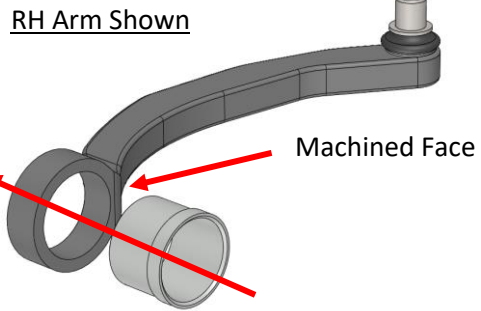

Step 3:
Apply washing-up liquid to the leading edge of the bush and press in using a vice or hydraulic press until the bush is fully seated.

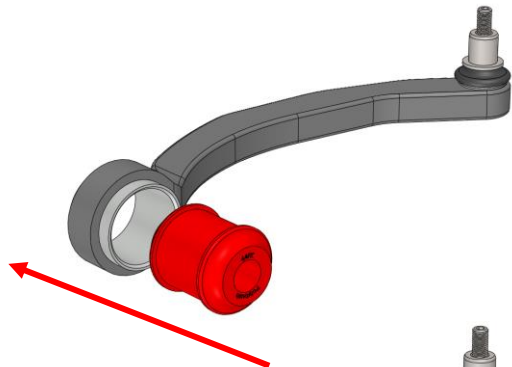

Step 4:
Press in Inner Tube until flush.

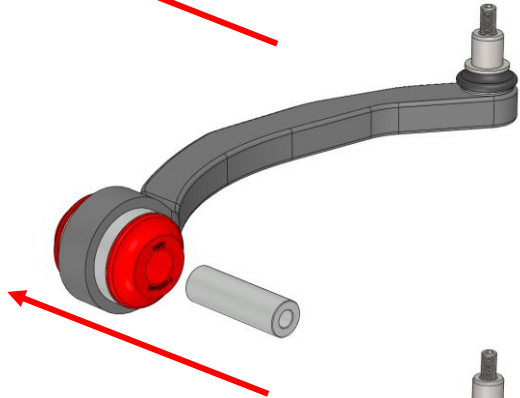

Step 5:
Refit and torque to car when at ride height using the manufacturers torque settings.

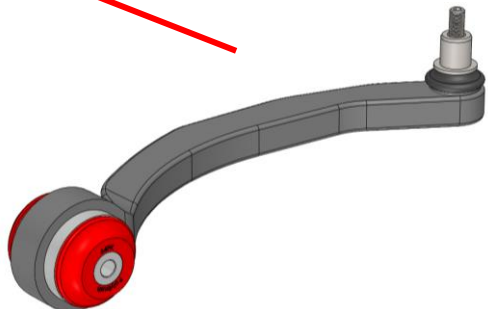

If you have any questions regarding the fitment of these bushes, please give us a ring on 01978 664316.
or send an e-mail to sales@polybush.co.uk