

ITEM NO.	PART NUMBER	DESCRIPTION	QTY.
1	1510-1, Bush		1
2	1510-2, Reduced Bush		1
3	1510-3, 5mm Washer		1

Fitment notes:

The parts are numbered from top to bottom of the car.

If the car is running AST shock absorbers, item #3 needs to be removed as these shock absorbers have shorter threads than others. This is valid for any type of shocks that have a shorter thread length.

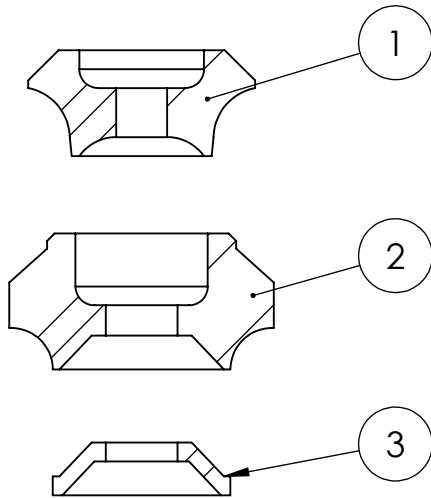

SECTION A-A

PROPRIETARY AND CONFIDENTIAL
 THE INFORMATION CONTAINED IN THIS DRAWING IS THE SOLE PROPERTY OF <INSERT COMPANY NAME HERE>. ANY REPRODUCTION IN PART OR AS A WHOLE WITHOUT THE WRITTEN PERMISSION OF <INSERT COMPANY NAME HERE> IS PROHIBITED.

		UNLESS OTHERWISE SPECIFIED:		NAME	DATE	
		DIMENSIONS ARE IN INCHES	DRAWN			TITLE:
		TOLERANCES:	CHECKED			
		FRACTIONAL ±	ENG APPR.			
		ANGULAR: MACH ± BEND ±	MFG APPR.			
		TWO PLACE DECIMAL ±	Q.A.			
		THREE PLACE DECIMAL ±	COMMENTS:			
		INTERPRET GEOMETRIC TOLERANCING PER:				SIZE DWG. NO. REV
		MATERIAL				ADG assembly
NEXT ASSY	USED ON	FINISH				SCALE: 1:2 WEIGHT: SHEET 1 OF 1
APPLICATION		DO NOT SCALE DRAWING				